



|                        |                         |         |
|------------------------|-------------------------|---------|
| inserts:               |                         | page:   |
| CD .....               | 40 poles + ⊕            | 57      |
| CT, CTS (10A) *) ..... | 40 poles + ⊕            | 64      |
| CDD .....              | 72 poles + ⊕            | 70      |
| CDS .....              | 27 poles + ⊕            | 80      |
| CSH .....              | 16 poles + ⊕            | 93      |
| CNE, CSE .....         | 16 poles + ⊕            | 106     |
| CCE .....              | 16 poles + ⊕            | 112     |
| CSS .....              | 16 poles + ⊕            | 124     |
| CT, CTSE (16A) *) ..   | 16 poles + ⊕            | 132     |
| CQE .....              | 32 poles + ⊕            | 140     |
| CQEE .....             | 40 poles + ⊕            | 146     |
| CMCE, CMSH 6+2 (aux)   | poles + ⊕               | 150-151 |
| CP .....               | 6 poles + ⊕             | 162     |
| CX .....               | 6/36 and 12/2 poles + ⊕ | 170-171 |
| CX .....               | 4/0 and 4/2 poles + ⊕   | 172     |
| MIXO .....             | 4 modules               | 179-215 |

\*) can be used only in bulkhead mounting housings

insert centre distance: 77,5 x 27 mm

bulkhead mounting housings for central lever



surface mounting housings, high construction with two entries for central lever



| description   | part No.         | part No.            | entry Pg | part No.            | entry M |
|---|------------------|---------------------|----------|---------------------|---------|
| bulkhead mounting with pegs for central lever                     | <b>CHI 16 YC</b> |                     |          |                     |         |
| surface mounting, high construction, with pegs, for central lever |                  | <b>CAP 16 YC229</b> | 29x2     | <b>MAP 16 YC232</b> | 32x2    |

panel cut-out for bulkhead mounting housings in mm

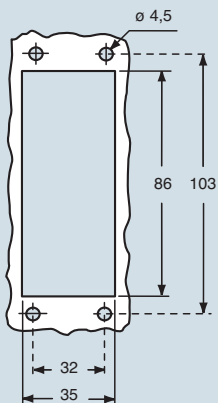

dimensions in mm

CHI YC

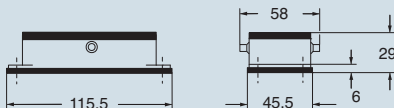

dimensions in mm

CAP YC and MAP YC

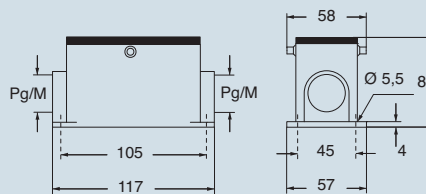

Even when coding is not required, it is recommended to use CRM and CRF pins with CD and CDD inserts and CRM CX and CRF CX pins with MIXO inserts to reduce movements when fitting and removing the connectors and to avoid contact damages. Within this scope, the DIN 43 652 standard requires a maximum angular longitudinal fluctuation of ±5°.

**CRUS** Type 4/4X/12



dimensions shown are not binding and may be changed without notice

CENTRAL LEVER - size 77.27



|                |                         |         |
|----------------|-------------------------|---------|
| inserts:       |                         | page:   |
| CD .....       | 40 poles + ⊕            | 57      |
| CDD .....      | 72 poles + ⊕            | 70      |
| CDS .....      | 27 poles + ⊕            | 80      |
| CSH .....      | 16 poles + ⊕            | 93      |
| CNE, CSE ..... | 16 poles + ⊕            | 106     |
| CCE .....      | 16 poles + ⊕            | 112     |
| CSS .....      | 16 poles + ⊕            | 124     |
| CQE .....      | 32 poles + ⊕            | 140     |
| CQEE .....     | 40 poles + ⊕            | 146     |
| CMCE .....     | 6+2 (aux) poles + ⊕     | 150     |
| CMSH .....     | 6+2 (aux) poles + ⊕     | 151     |
| CP .....       | 6 poles + ⊕             | 162     |
| CX .....       | 6/36 and 12/2 poles + ⊕ | 170-171 |
| CX .....       | 4/0 and 4/2 poles + ⊕   | 172     |
| MIXO .....     | 4 modules               | 179-215 |

insert centre distance:  
77,5 x 27 mm

hoods with central lever



hoods with central lever



| description                   | part No.           |    | entry Pg           |    | part No.           |    | entry M            |    |
|-------------------------------|--------------------|----|--------------------|----|--------------------|----|--------------------|----|
|                               |                    |    |                    |    |                    |    |                    |    |
| side entry, high construction | <b>CAO 16 YX21</b> | 21 | <b>MAO 16 YX32</b> | 32 |                    |    |                    |    |
| side entry, high construction | <b>CAO 16 YX29</b> | 29 | <b>MAO 16 YX40</b> | 40 |                    |    |                    |    |
| top entry, high construction  |                    |    |                    |    | <b>CAV 16 YX21</b> | 21 | <b>MAV 16 YX32</b> | 32 |
| top entry, high construction  |                    |    |                    |    | <b>CAV 16 YX29</b> | 29 | <b>MAV 16 YX40</b> | 40 |

Even when coding is not required, it is recommended to use CRM and CRF pins with CD and CDD inserts and CRM CX and CRF CX pins with MIXO inserts to reduce movements when fitting and removing the connectors and to avoid contact damages. Within this scope, the DIN 43 652 standard requires a maximum angular longitudinal fluctuation of ±5°.

dimensions in mm

CAO..YX and MAO..YX

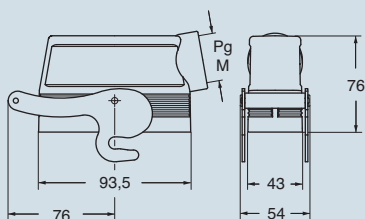

dimensions in mm

CAV..YX and MAV..YX

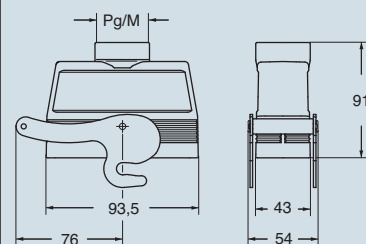

**CRUS**® Type 4/4X/12



dimensions shown are not binding and may be changed without notice

CENTRAL LEVER - size 77.27