

Product	<b>Contacts: 3, female panel mount connector</b>	Area	<b>Micro Push-Pull IP67 Series 420</b>
Pole	<b>3</b>	Article number	<b>09 4708 00 03</b>

### Illustration

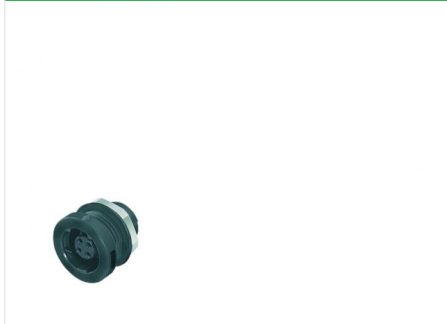

### Scale drawing

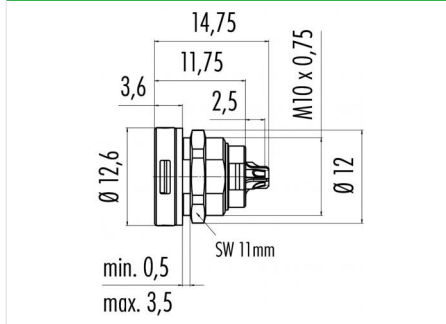

### Contact Arrangement

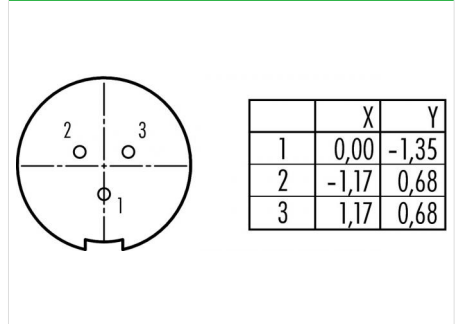

You can find the item description and assembly instruction on the next page.

## Technical data

### Common values

Connector Design	Female panel mount connector
Connector locking system	Micro Push-Pull
Termination	Solder
Wire gauge (mm)	0.14 mm <sup>2</sup>
Wire gauge (AWG)	26
Upper temperature	80 °C
Lower temperature	-40 °C

### Cable data

material housing	-
Insulation single lead	-
Single lead structure	-
Conductor resistance	-

### Electrical values

Rated voltage	125 V
Rated impulse voltage	1500 V
Pollution degree	2
Overvoltage category	II
Material group	II
Rated current (40°C)	1 A
Volume resistivity	≤ 8 mΩ
EMV compliance	not shieldable
Degree of protection	IP67
Mechanical operation	> 1000 mating cycles

### Material

Material of contact	CuSn (Bronze)
Contact plating	Au (Gold)
Material of contact body	PA
Material of housing	PA

Contacts: 3, female panel mount connector

Product  
Pole

Contacts: 3, female panel mount  
connector  
3

Area  
Article number

Micro Push-Pull IP67 Series 420  
09 4708 00 03

Item description

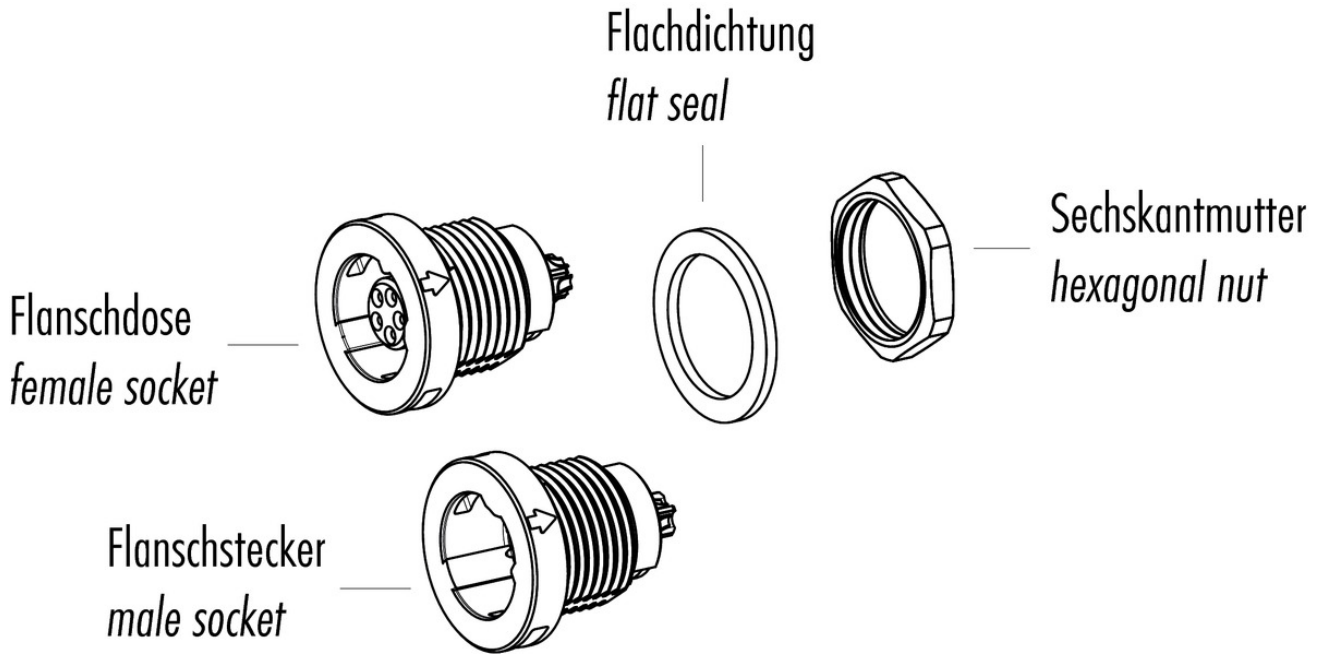

Installation instructions / Mounting cutout

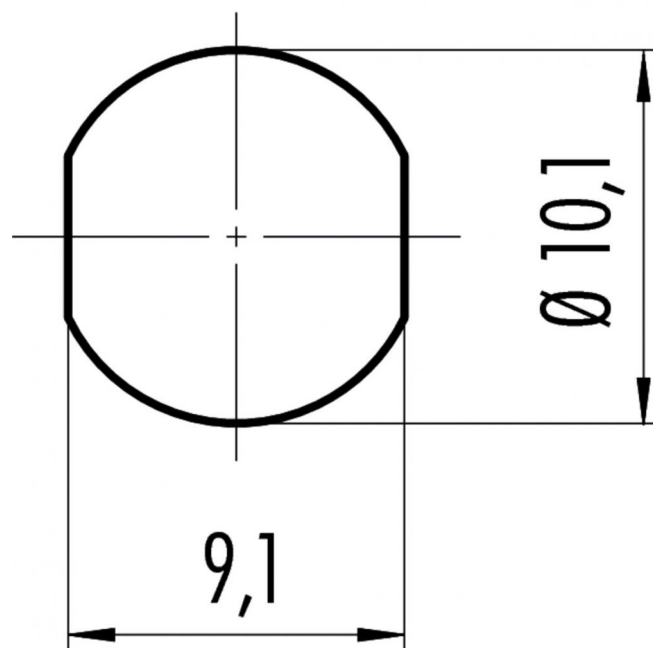

Product

**Contacts: 3, female panel mount connector**

Area

**Micro Push-Pull IP67 Series 420**

Pole

**3**

Article number

**09 4708 00 03**

## Installation instructions / Mounting cutout

1. Abmanteln auf L = 9mm.  
Ummantelung abstreifen.
2. Dichtung in Klemmvorrichtung montieren.  
Druckschraube und Verriegelungseinheit auf Kabel aufstecken.
3. Litzen abisolieren (l = 3mm) und verzinnen.
4. Einsätze anlöten.
5. Verriegelungseinheit orientiert, Pfeilrichtung beachten, aufschieben und aufschrauben.
6. Druckschraube aufschieben und vor dem Festziehen an Schlüsselfläche kontorn.

(Bei Demontage zuerst Druckschraube öffnen)

1. Strip to 9mm length and remove cable jacket.
2. Mount sealing ring to clamp device to cable. Bead pressing screw and clamp device.
3. Strip the insulation off the wires (l = 3mm) and tin them.
4. Solder wires to solder cups.
5. Align locking unit, bear in mind direction of arrow, push forward and screw tightly.
6. Push pressing screw forward and secure them at flats.

(Before unmounting first open pressing screw.)

