



inserts:		page:
CDD	24 poles + ⊕	67
CDS	9 poles + ⊕	78
CSH	6 poles + ⊕	91
CNE, CSE	6 poles + ⊕	104
CCE	6 poles + ⊕	110
CSS	6 poles + ⊕	122
CT, CTSE (16A) *)	6 poles + ⊕	130
CQE	10 poles + ⊕	138
MIXO	2 modules	179 - 215

*) can be used only in bulkhead mounting housings

insert centre distance:
44 x 27 mm

bulkhead mounting housings for central lever



surface mounting housings, high construction with two entries for central lever



description	part No.	part No.	entry Pg	part No.	entry M
bulkhead mounting with pegs for central lever	CHI 06 YC				
surface mounting, high construction, with pegs, for central lever		CAP 06 YC229	29x2	MAP 06 YC232	32x2

panel cut-out for bulkhead mounting housings in mm

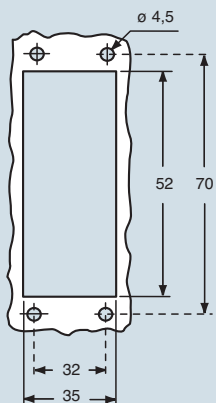

dimensions in mm

CHI YC

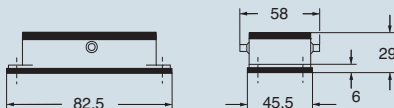

dimensions in mm

CAP YC and MAP YC

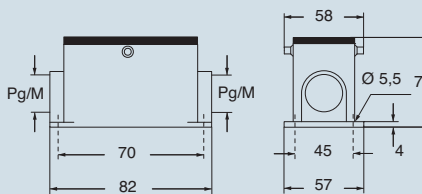

Even when coding is not required, it is recommended to use CRM and CRF pins with CD and CDD inserts and CRM CX and CRF CX pins with MIXO inserts to reduce movements when fitting and removing the connectors and to avoid contact damages. Within this scope, the DIN 43 652 standard requires a maximum angular longitudinal fluctuation of ±5°.

CRUS® Type 4/4X/12



dimensions shown are not binding and may be changed without notice

CENTRAL LEVER - size 44.27



inserts:		page:
CDD	24 poles + ⊕	67
CDS	9 poles + ⊕	78
CSH	6 poles + ⊕	91
CNE, CSE	6 poles + ⊕	104
CCE	6 poles + ⊕	110
CSS	6 poles + ⊕	122
CQE	10 poles + ⊕	138
MIXO	2 modules	179 - 215

insert centre distance:
44 x 27 mm

hoods with central lever



hoods with central lever



description	part No.		entry Pg		part No.		entry M	
side entry, high construction	CAO 06 YX21	21	MAO 06 YX25	25				
side entry, high construction	CAO 06 YX29	29	MAO 06 YX32	32				
top entry, high construction					CAV 06 YX21	21	MAV 06 YX25	25
top entry, high construction					CAV 06 YX29	29	MAV 06 YX32	32

Even when coding is not required, it is recommended to use CRM and CRF pins with CD and CDD inserts and CRM CX and CRF CX pins with MIXO inserts to reduce movements when fitting and removing the connectors and to avoid contact damages. Within this scope, the DIN 43 652 standard requires a maximum angular longitudinal fluctuation of ±5°.

dimensions in mm

CAO..YX and MAO..YX

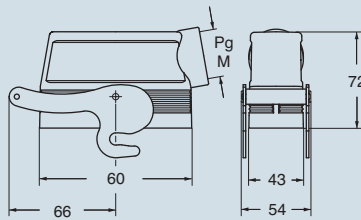

dimensions in mm

CAV..YX and MAV..YX

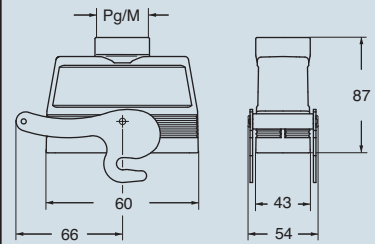

CRUS® Type 4/4X/12



dimensions shown are not binding and may be changed without notice

CENTRAL LEVER - size 44.27