

Product **female panel mount connector SMT, with housing**

Area **M12-A Series 713/763**
Article number **99 3432 351 04**

Illustration



Scale drawing

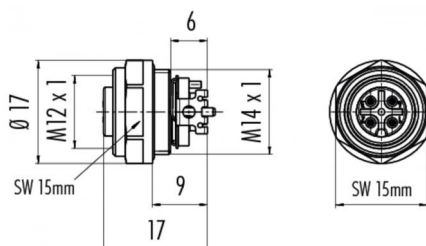

Contact Arrangement

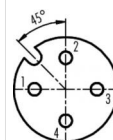

	X	Y
1	-2,50	0,00
2	0,00	2,50
3	2,50	0,00
4	0,00	-2,50

- 1 braun/brown
- 2 weiß/white
- 3 blau/blue
- 4 schwarz/black

Geschirmte Versionen: Schirm auf Gehäuse
Shielded versions: shield on housing

Technical data

General features

Connector Design integrated socket
Termination SMT
Upper temperature 85 °C
Lower temperature -40 °C

Electrical parameters

Rated voltage 250 V
Rated impulse voltage 2500 V
Pollution degree 3
Overvoltage category II
Material group III
Rated current (40°C) 4A
Volume resistivity ≤ 3 mΩ
EMV compliance not shielded
Degree of protection IP67
Mechanical operation > 100 Mating cycles

Material

Material of contact CuSn (Bronze)
Contact plating Au (gold)
Material of contact body LCP - GF30