

Product **female panel mount connector SMT, shieldable**

Area **M12-A Series 713/763**  
Article number **09 0434 601 05**

### Illustration



### Scale drawing

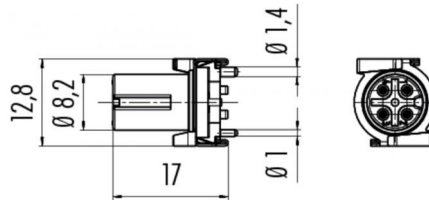

### Contact Arrangement

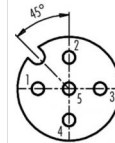

|   | X     | Y     |
|---|-------|-------|
| 1 | -2,50 | 0,00  |
| 2 | 0,00  | 2,50  |
| 3 | 2,50  | 0,00  |
| 4 | 0,00  | -2,50 |
| 5 | 0,00  | 0,00  |

- 1 braun/brown
- 2 weiß/white
- 3 blau/blue
- 4 schwarz/black
- 5 grau/grey

Geschirmte Versionen: Schirm auf Gehäuse  
Shielded versions: shield on housing

## Technical data

### General features

|                   |                   |
|-------------------|-------------------|
| Connector Design  | integrated socket |
| Termination       | SMT               |
| Upper temperature | 85 °C             |
| Lower temperature | -40 °C            |

### Electrical parameters

|                       |                     |
|-----------------------|---------------------|
| Rated voltage         | 60 V                |
| Rated impulse voltage | 1500 V              |
| Pollution degree      | 3                   |
| Overvoltage category  | II                  |
| Material group        | III                 |
| Rated current (40°C)  | 4 A                 |
| Volume resistivity    | ≤ 3 mΩ              |
| Degree of protection  | IP67                |
| Mechanical operation  | > 100 Mating cycles |

### Material

|                          |               |
|--------------------------|---------------|
| Material of contact      | CuSn (Bronze) |
| Contact plating          | Au (gold)     |
| Material of contact body | LCP - GF30    |