

Product **Polzahl 4: Einbaustecker, SMT, mit Gehäuse, schirmbar, Einbauhöhe 9mm**  
 Area **M12-A Series 713/763**  
 Article number **99 3431 401 04**

Illustration	Scale drawing	Contact Arrangement															
		<table border="1" data-bbox="1193 616 1324 728"> <thead> <tr> <th></th> <th>X</th> <th>Y</th> </tr> </thead> <tbody> <tr> <td>1</td> <td>2,50</td> <td>0,00</td> </tr> <tr> <td>2</td> <td>0,00</td> <td>2,50</td> </tr> <tr> <td>3</td> <td>-2,50</td> <td>0,00</td> </tr> <tr> <td>4</td> <td>0,00</td> <td>-2,50</td> </tr> </tbody> </table> <p>1 braun/brown                  2 weiß/white                  3 blau/blue                  4 schwarz/black</p> <p>Geschirmte Versionen: Schirm auf Gehäuse                  Shielded versions: shield on housing</p>		X	Y	1	2,50	0,00	2	0,00	2,50	3	-2,50	0,00	4	0,00	-2,50
	X	Y															
1	2,50	0,00															
2	0,00	2,50															
3	-2,50	0,00															
4	0,00	-2,50															

You can find the assembly instruction on the next page.

## Technical data

### General features

Connector Design	integrated plug
Connector locking system	bolted
Termination	dip-solder
Upper temperature	85 °C
Lower temperature	-40 °C

### Electrical parameters

Rated voltage	250 V
Rated impulse voltage	2500 V
Pollution degree	3
Overvoltage category	II
Material group	III
Rated current (40°C)	4 A
Volume resistivity	≤ 3 mΩ
EMV compliance	shieldable
Degree of protection	IP67
Mechanical operation	> 50 Mating cycles

### Material

Material of contact	CuZn (Messing)
Contact plating	Au (gold)
Material of contact body	LCP

Product **Polzahl 4: Einbaustecker, SMT, mit Gehäuse, schirmbar, Einbauhöhe 9mm**  
Area **M12-A Series 713/763**  
Article number **99 3431 401 04**

Installation instructions / Mounting cutout

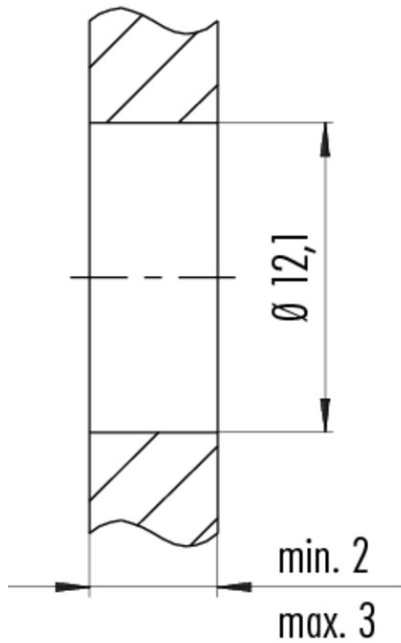

Anzugsdrehmoment / *Tightening moment*  
M12 x 1      6,25 Nm